

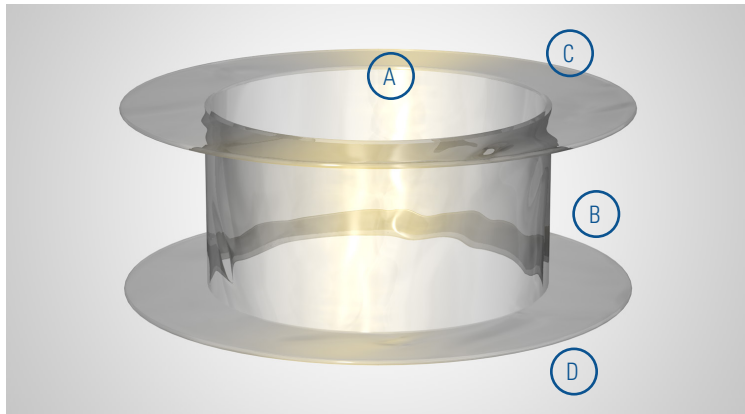

SIFT-SOCK SKETCH FORM

Straight Cylindrical Connector with Flanged Ends



A: TUBE DIAMETER (IN/MM):

B: TUBE LENGTH (IN/MM):

C: TOP OF TUBE FLANGE DIAMETER (IN/MM):

D: BOTTOM OF TUBE FLANGE DIAMETER (IN/MM):

NUMBER OF SUPPORT, NON COLLAPSE RINGS:

BOLT HOLES AT "C" YES NO

DIAMETER OF BOLTS (IN/MM):

NUMBER OF HOLES:

BOLT CIRCLE DIAMETER (IN/MM):

BOLT HOLES AT "D" YES NO

DIAMETER OF BOLTS (IN/MM):

NUMBER OF HOLES:

BOLT CIRCLE DIAMETER (IN/MM):

MATERIALS:

COMMENTS:

APPROVED BY:

*Custom Sift-Socks are non-refundable & non-returnable, except in cases of manufacturing defect.
Please confirm the dimensions, construction and material(s) are accurate.*

YOUR NAME

COMPANY

PHONE

EMAIL

SIFTEX DRAWING NUMBER:

SIFTEX PART NUMBER:

PRICE:

LEAD TIME:

FOR A PROMPT QUOTE FAX/EMAIL THIS FORM TO
860.289.8744 OR CUSTOMERSERVICE@SIFTEX.COM

OFFICE 52D CONNECTICUT AVENUE
SOUTH WINDSOR, CONNECTICUT 06074
WEBSITE WWW.SIFTEX.COM

EMAIL CUSTOMERSERVICE@SIFTEX.COM
PHONE 800-274-3839 / 860-289-8779
FAX 860-289-8744

*Siftex is focused on helping you spend less time with downtime
by providing the innovative products, personal attention, superior
customer service and on-time deliveries you expect.*

